

Salamol CFC-Free Inhaler

Salbutamol Sulphate 100mcg/actuation

What is in this leaflet

1. What Salamol is used for
2. How Salamol works
3. Before you use Salamol
4. How to use Salamol
5. While you are using it
6. Side effects
7. Storage and Disposal of Salamol
8. Product Description
9. Manufacturer and Product Registration Holder
10. Date of revision

WHAT SALAMOL IS USED FOR

Salamol is used to treat asthma. It can also be used to prevent asthma caused by exercise or asthma caused by a reaction to allergens (substances to which you are allergic to e.g. house dust, pollen, dog hair, cat hair, cigarette smoke, etc.) or to treat breathing difficulties associated with reversible airways obstruction (e.g. chronic bronchitis)

This type of medicine is known as a 'reliever'. You may be using another medicine to prevent you from having an asthma attack ("preventer"). You can safely use your preventer with this medicine.

HOW SALAMOL WORKS

Salamol contains salbutamol sulphate, which belongs to a group of medicines called beta agonists. Salbutamol is a bronchodilator and works by widening the airways in your lungs to allow air in and out. This helps you to feel less breathless, wheezy or tight-chested.

BEFORE YOU USE SALAMOL

When you must not use it

- If you are allergic to salbutamol (active ingredient) or any of the

other ingredients in this medicine.

Before you start to use it

Let your doctor know if you suffer from thyroid problems, diabetes, serious heart disease, fast irregular heart rhythms or high blood pressure.

Tell your doctor if you have a condition known as hypoxia (a disorder where the oxygen level in the blood is low and may cause breathlessness) or if you have a history of heart disease.

Consult a doctor immediately if your usual treatment is not working or you need more than 8 puffs per day (for adults) or 4 puffs per day (for children) or in case of worsening asthma symptoms. Your dosage should only be increased on medical advice.

Taking other medicines

Please tell your doctor or pharmacist if you are taking or have recently taken any other medicines, including medicines that you obtained without a prescription.

If you are having treatment that requires a general anaesthetic, please tell your anaesthetist that you are taking Salamol. Do not use this medicine for at least six hours before the intended anaesthetic.

Salbutamol can reduce the amount of potassium in your blood. If this happens, you may notice an irregular heartbeat, muscle weakness or cramp. This is more likely to happen if you use salbutamol with some medicines used to treat high blood pressure, other medicines used to treat breathing problems (e.g. steroids), stimulants (e.g. xanthines).

The following medicines may influence the effect of Salamol:

- Some medicines for the treatment of high blood pressure such as beta-blockers (e.g. propranolol);
- Medicines used to treat heart disease (e.g. digoxin);
- Medicines for the treatment of depression (from the monoamine oxidase inhibitor group e.g. phenelzine or tricyclic antidepressants e.g. amitriptyline);
- Water tablets (diuretics);

Pregnancy and breast-feeding

Ask your doctor or pharmacist for advice before taking any medicine. Salamol should only be used if recommended by a doctor.

HOW TO USE SALAMOL

How much to use

Always use this medicine exactly as your doctor has told you to. You should check with your doctor or pharmacist if you are not sure.

The dosage is individually adjusted according to your doctor's instructions, based on previous asthma therapy.

The usual dose for Salamol is:

Adults and the elderly:

For the best results with this medicine you should use it when required to relieve symptoms of asthma and other chest conditions with similar symptoms, such as wheezing, breathlessness and tightness in your chest. Take one puff as a starting dose. This may be increased to two puffs if necessary.

To prevent asthma caused by exercise or allergens (e.g.

house dust, pollen etc), take two puffs 10-15 minutes before you exercise or before exposure to known allergens.

Do not take more than eight puffs in 24 hours. Wait 4 hours between doses.

Children:

The usual dose for children under the age of 12 years to relieve asthma symptoms such as wheezing, breathlessness and tightness in the chest, is one puff as a starting dose. This may be increased to two puffs if necessary.

The usual dose for children to prevent asthma caused by exercise or allergens (e.g. house dust, pollen etc), is one puff 10-15 minutes before exercise or before exposure to known allergens. This can be increased to two puffs if necessary.

When to use it

Use as directed by your doctor or pharmacist.

How long to use it

Continue taking *salamol 100 CFC Free Inhaler* for as long as your doctor recommends.

Instructions for use

Important

Before using this medicine, please read this leaflet carefully and follow the instructions.

An adult should always supervise children when they use Salamol. Children may need help to use their inhaler. Parents can help by spraying the aerosol when the child begins to breathe in.

Always remember the following:

- Wait four hours between doses.
- Tell your doctor if your asthma gets worse or if the inhaler does not provide as

much relief from your asthma as before.

- You should sit or stand upright while taking this medicine. It is important when using this medicine to hold the inhaler upright as it will not work if it is not held in this position.

Test spray the inhaler by firing two shots into the air before you use it for the first time and also if you have not used it for a period of five days or more.

Using the Inhaler

1. Take the cap off the inhaler. Make sure the mouthpiece is clean and clear of fluff and dirt.

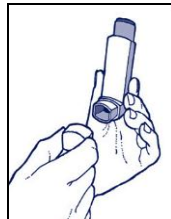

2. Hold the inhaler upright, with your thumb on the base and your first finger on the top of the canister. Now shake the inhaler vigorously up and down.

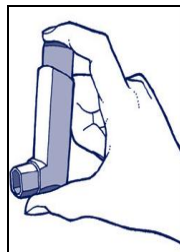

3. Breathe out normally as far as you comfortably can. Then hold the mouthpiece firmly between your lips.



4. Breathe in slowly and deeply. At the same time as you start to breathe in, press the aerosol can with your first finger to spray the aerosol and release the medicine. Continue to breathe in slowly and deeply.



5. Take the inhaler out of your mouth and hold your breath for 10 seconds, or for as long as you comfortably can. Breathe out slowly.
6. If you need more than one puff, wait about one minute and then start again from step 2. Put the cap back on the inhaler.
7. You must keep your inhaler clean, especially in the mouthpiece. This will prevent deposits from the aerosol building up. To prevent your inhaler becoming blocked you must clean it once a week.
8. What to do if your inhaler stops working properly?
It is important to clean your inhaler regularly to prevent deposits

from the aerosol building up and blocking the inhaler. If your inhaler does not seem to be working, it may be that your inhaler has become blocked and you should clean your inhaler according to the section "Cleaning the inhaler". If your inhaler still does not work, return it to your doctor or pharmacist.

Important: Do not rush steps 3 and 4. It is important that you start to breathe in as slowly as possible just before using your inhaler. Practice in front of the mirror for the first few times. If you see "mist" coming from the top of the inhaler or the sides of your mouth you should start again from step 2.

*Note: Children and people with weak hands may find it easier to hold the inhaler with both hands, in this case for step 2 put your two first fingers on the top of the can and both thumbs on the base of the inhaler.

✓This product can be used with the Volumatic® Spacer.

Cleaning the inhaler

Keeping the plastic mouthpiece clean is very important as it will help prevent your inhaler becoming blocked. You must clean your inhaler once a week.

A To clean your inhaler first remove the mouthpiece cap.

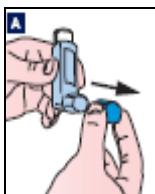

B Remove the metal can from the plastic mouthpiece.

Do not put the metal can into water.

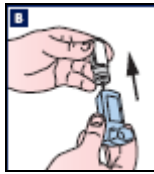

C Rinse the inhaler mouthpiece and the mouthpiece cap with warm running water for at least 30 seconds.



D Shake off any excess water and dry the plastic mouthpiece and mouthpiece cap thoroughly (leave to dry overnight if possible) but do not use direct heat. Put the metal can back in your inhaler. Replace the cap.

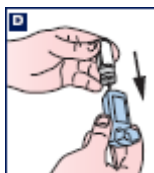

Failure to allow the mouthpiece to dry properly will result in an increase in blockage problems.

If you need to use your inhaler before it is dry, shake off any water from the plastic mouthpiece and put the can back in. Test spray the inhaler by firing two puffs in the air before taking your usual dose.

Wash and dry the mouthpiece again as described above.

If you forget to use it

Consult your doctor or pharmacist on what you should do if you forget to use it.

Take the missed dose as soon as you remember. If it is almost time for your next dose, wait until then to take the medicine and skip the missed dose. Do not take a double dose to make up for the missed dose.

If you use too much Salamol (overdose)

It is important that you take your dose as stated on the pharmacist's label or as advised by your doctor. You should not increase or decrease your dose without seeking medical advice.

If you accidentally take a larger dose than recommended, you may notice that your heart is beating faster than usual, that you feel shaky or tense, you may have a headache and your skin may look flushed and feel hot. These effects usually wear off in a few hours, but you should tell your doctor as soon as possible. Your doctor may want to check your blood potassium levels.

WHILE YOU ARE USING IT

Things you must do

Take your medicine exactly as your doctor has told you.

Tell all the doctors, dentists and pharmacists treating you that you are taking Salamol.

Tell your doctor immediately if you become pregnant while taking this medication.

Things you must not do

Do not stop taking the medicine unless advised by your doctor.

Do not take any new medicines without consulting your doctor.

Do not give Salamol CFC Free Inhaler to anyone else, even if they have the same symptoms or condition as you.

Things to be careful of

If you experience any side effects, consult your doctor or pharmacist for advice.

SIDE EFFECTS

Like all medicines Salamol can cause side effects, although not everybody gets them.

Contact your doctor immediately if you experience allergic (hypersensitivity) reactions. These include:

- Wheezing, coughing and difficulty breathing;
- Rash, swelling of the face and throat and a fall in blood pressure.
- Sleep disturbances, hallucinations, tense, dizziness, increased heart rate, nausea and vomiting

If any of the side effects get serious, or if you notice any side effects not listed in this leaflet, please tell your doctor or pharmacist, but do not stop using this medicine unless you are told to do so.

You may report any side effects or adverse drug reactions directly to the National Centre for Adverse Drug Reaction Monitoring by calling Tel: 03- 78835550, or visiting the website portal.bpfk.gov.my (Consumer-> Reporting)

STORAGE AND DISPOSAL OF SALAMOL

Storage

Keep out of the reach and sight of children. Protect from direct sunlight and frost.

Do not store above 25°C.

Do not refrigerate or freeze. If this medicine gets very cold, remove the metal can from the inhaler and warm it in your hands for a few minutes before you use it. Do not warm the can in any other way.

Pressurised aerosol can. Do not puncture, break or burn the can, even if it seems empty.

Do not use this medicine after the expiry date which is stated on the label and carton.

Disposal

Medicines should not be disposed of via wastewater or household waste. Ask your pharmacist how to dispose of medicines no longer required. These measures will help to protect the environment.

PRODUCT DESCRIPTION

What it looks like

Each pack of Salamol CFC-Free Inhaler contains a single inhaler that supplies 200 metered doses.

For inhalation use. Pressurised Inhalation, Solution.

Ingredients

- The active substance is salbutamol sulphate equivalent to 100 micrograms of salbutamol in each puff (metered dose).
- The other ingredients are ethanol anhydrous (alcohol) and the propellant norflurane (HFA-134a). This medicine does not contain any CFCs.

Registration Number

MAL07081484A

MANUFACTURER AND PRODUCT REGISTRATION HOLDER

Manufacturer:

IVAX Pharmaceuticals Ireland
IDA Industrial Park
Waterford
Ireland

Product Registration Holder:

Averroes Pharmaceuticals Sdn.Bhd.
11E, Level 5, Block 1
Worldwide Business Center
Jalan 13/50, Section 13, 40000
Shah Alam
Malaysia
Tel: +603 55118928
Fax: +603 55118918

**DATE OF REVISION
28 October 2014**

Serial Number:

BPFK(R4/1)271014/00038